

PARTS LIST

REF. No.	PARTS No.		PARTS NAME	Q'TY			PRICE()	RECOMM.(%) Lot.100	REMARKS
				INCLUDING					
1	36122	122	KNAPSACK FRAME	1					
2	91027	135	KNAPSACK PAD	1					
3	11121	106 104	SUPPORT C.P. (VIBRO-ISOLATING)	1					
4	36005	167	RUBBER	3					
5	584L	0600	U-FLANGE NUT	3				M6	
6	561L	0600	U-HEXAGON NUT	3				M6	
7	68036	125	WASHER	3					
8	318L	0612	(+) HEXAGON BOLT (W/SW)	4				M6×12	
9	11113	360	STAY	1					
10	11113	359	STAY	1					
11	68036	158	WASHER	4					
12	71223	142	SUPPORT ASS'Y (ENGINE)	1					
13	11020	137	ENGINE SUPPORT		1				
14	31013	111	BASE BOLT		1				
15	68036	196	WASHER		1				
16	571L	1000	FLANGE NUT		1			M10	
17	513L	1000	HEXAGON NUT	1				M10	
18	36071	144	BAND	1					
19	661L	1000	SPRING LOCK WASHER	1				M10	
20	71304	118	SINGLE HANDLE SET	1					
21	51023	153	SINGLE HANDLE		1				
22	71138	117	HANDLE BRACKET SET		1				
23	416N	0535	SOCKET SCREW			4		M5×35 (SW,PW)	
24	51116	161	HANDLE BRACKET			1			
25	71038	172	GUARD BAND SET	1					
26	412N	0615	SOCKET SCREW		2			M6×15	
27	11029	132	SAFETY GUARD BAND		1				
28	11029	139	SAFETY GUARD BAND	1					

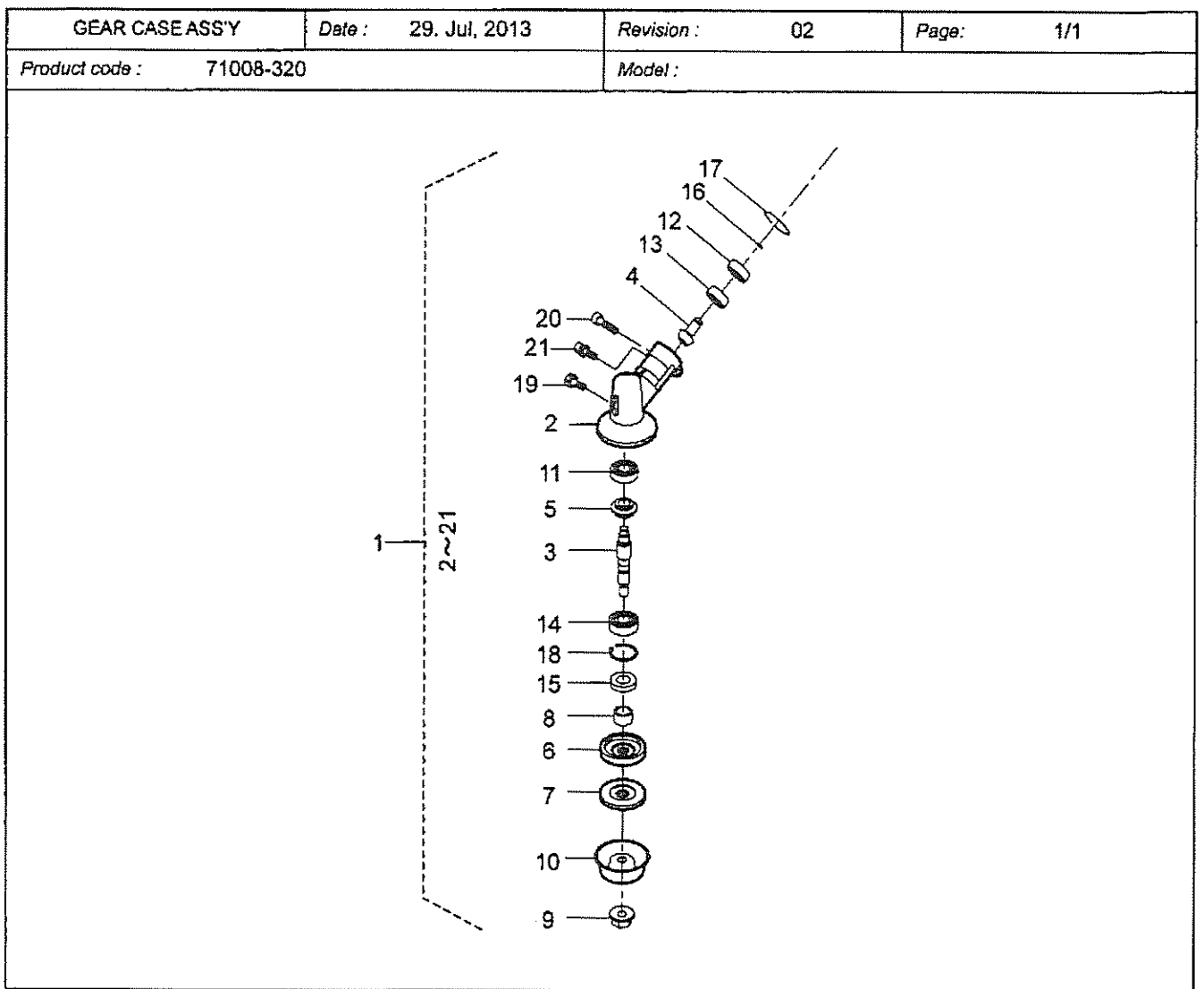

Gear case ass'y (A): 71008-320
 Brand: Date: 29-Jul-2013 (B):
 P.cd: 71008-320 Revision: 02 (C):

Ref.No	Parts.No	Parts.Name	Q'ty			Remarks	Recomm(%) Lot.100
			(A)	(B)	(C)		
1	71008-320	GEAR CASE ASS'Y	1				3
2	51001-267	GEAR CASE	1				1
3	64001-144	SPLINE SHAFT	1				3
4	78002-174	BEVEL PINION	1				1
5	78001-150	BEVEL GEAR	1				1
6	11001-150	HOLDER(A)	1				3
7	11002-126	HOLDER(B)	1				3
8	61001-119	SPLINE SLEEVE	1				1
9	31001-106	SAW LOCK NUT	1				5
10	11027-119	STABILIZER	1				5
11	913B0629	BEARING (629)	1				1
12	912B6000	BEARING (6000ZZ)	1				1
13	913B6000	BEARING (6000)	1				1
14	919B6201	BEARING (6201C3)	1				1
15	61002-128	OIL SEAL (TC17328)	1				1
16	812V1000	C-SNAP RING	1				1
17	811V2600	C-SNAP RING	1				1
18	811V3200	C-SNAP RING	1				1
19	322N0810	(+)HEXAGON BOLT	1				1
20	412N0620	SOCKET SCREW	1				1
21	413N0515	SOCKET SCREW(W/SW)	1				1

