

### PARTS LIST

REF. No.	PARTS No.			PARTS NAME	Q'TY			PRICE( )	RECOMM.(%)		REMARKS
					INCLUDING				Lot.100		
1	71011	150	104	HANDLE JOINT ASS'Y	1				1		
2	51009	142	104	HANDLE JOINT(A)		1			1		
3	51010	145	104	HANDLE JOINT(B)		1			1		
4	51013	121	104	HANDLE JOINT(C)		1			1		
5	36005	162		RUBBER		2			1		
6	412N	0620		SOCKET SCREW		4			1		M6×20
7	412N	0625		SOCKET SCREW		2			1		M6×25
8	71014	447		HANDLE ASS'Y(R)	1				1		
9	71056	293		THROTTLE LEVER ASS'Y		1			1		
10	51002	126		WIRE HOLDER	2				1		
11	71014	345		HANDLE ASS'Y(L)	1				1		
12	36007	154		HANDLE GRIP		1			1		
13	71038	169		GUARD BAND SET	1				1		
14	11029	130		SAFETY GUARD BAND		1			1		
15	412N	0615		SOCKET SCREW		2			1		M6×15
16	11029	137		SAFETY GUARD BAND	1				1		
17	71303	114		SAFETY GUARD SET	1				1		
18	36046	160		SAFETY GUARD		1			3		
19	91014	177		BLADE		1			3		
20	474L	0410		(+)TAPPING SCREW		2			1		4×10
21	36063	152		SHOULDER BAND	1				1		
22	36044	107		BLADE COVER	1				1		
23	66006	117		BOX SPANNER	1				1		17×19+Screw driver
24	66007	103		L WRENCH	1				1		4mm
25	66007	104		L WRENCH	1				1		5mm
26	71001	124		GRASS COVER SET	1				3		

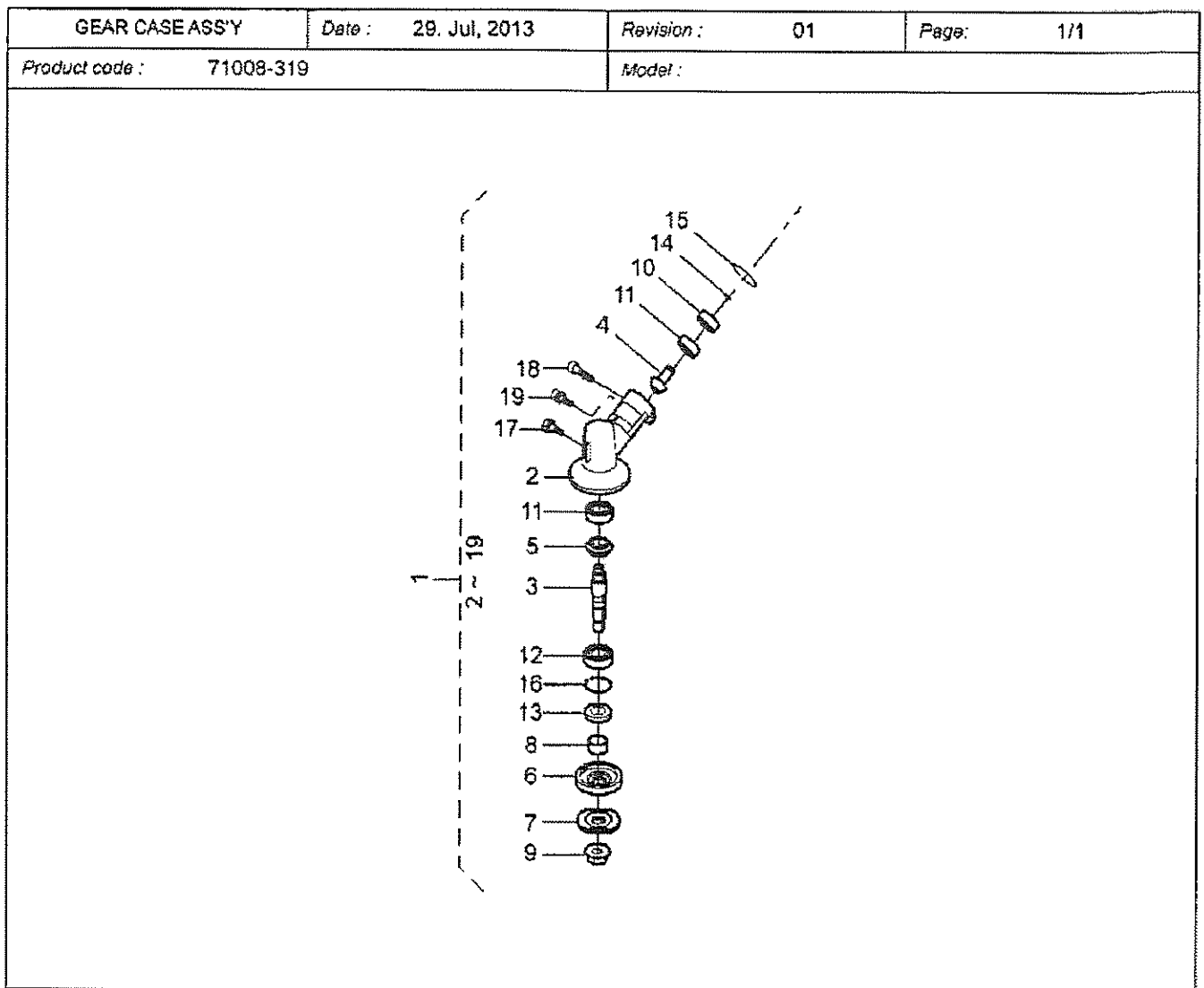

Gear case ass'y (A): 71008-319  
 Brand: Date: 29-Jul-2013 (B):  
 P.cd: 71008-319 Revision: 01 (C):

Ref.No	Parts.No	Parts.Name	Q'ty			Remarks	Recomm(%) Lot.100
			(A)	(B)	(C)		
1	71008-319	GEAR CASE ASS'Y	1				3
2	51001-266	GEAR CASE	1				1
3	64001-140	SPLINE SHAFT	1				3
4	78002-173	BEVEL PINION	1				1
5	78001-153	BEVEL GEAR	1				1
6	11001-148	HOLDER(A)	1				3
7	11002-115	HOLDER(B)	1				3
8	61001-121	SPLINE SLEEVE	1				1
9	31001-106	SAW LOCK NUT	1				5
10	912B6001	BEARING (6001ZZ)	1				1
11	913B6001	BEARING (6001)	2				1
12	919B6202	BEARING (6202C3)	1				1
13	61002-107	OIL SEAL (TC20357)	1				1
14	812V1200	C-SNAP RING	1				1
15	811V2800	C-SNAP RING	1				1
16	811V3500	C-SNAP RING	1				1
17	322N0810	(+)HEXAGON BOLT	1				1
18	412N0620	SOCKET SCREW	1				1
19	413N0515	SOCKET SCREW(W/SW)	1				1

